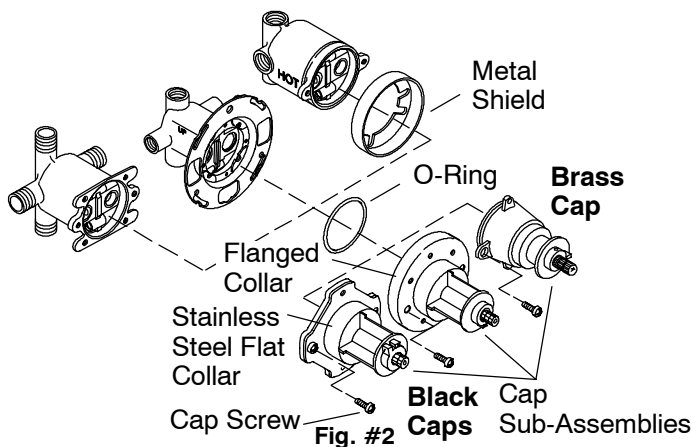

Fig. #1

1. See Fig. #1 for removal sequence of handle and faceplate. Do not damage parts. Be especially careful with ceramic parts. For Alterna handles, hold handle secure and rotate sleeve under handle to remove handle; for old style Alterna handles, as shown below, the insert is not held in place by a sleeve and may be removed by carefully prying with a thin blade. Clean and save all parts. If a spring and washer are present between the brass cap and the handle trim, remove and discard them only when replacing the brass cap with the black plastic cap. Make sure that both hot and cold water supplies to the valve are turned off before removing the valve cap.

2. Remove cap screw and pull out cap subassembly. If the cap includes a flanged collar, retain the collar for re-use. Discard cap subassembly. If installation includes metal shield, remove metal shield and discard. See Fig. #2 .



3. This step for Brass cap only: Note position of slotted or dimpled plunger on cap subassembly for reassembly. The concentric ring plunger should be on the cold water side of the valve. See Fig. #3 .

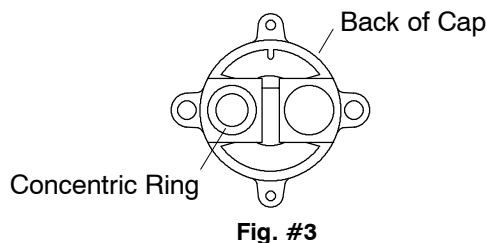

4. This step for pressure regulator replacement: Grip gently with a pliers on the center plastic rib of pressure regulator assembly. See Fig. #4 . Twist regulator slightly to the left and right while pulling straight out slowly. Discard old regulator.

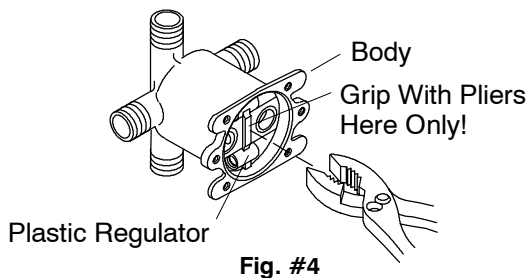

5. This step for pressure regulator replacement: Fit new O-rings on the new regulator as illustrated. See Fig. #5 . When orienting regulator, do not place pliers into the holes. When orienting regulator, note that there is no left or right side difference to the regulator. Make sure all O-rings are still in place, and reinstall new regulator assembly by gently pushing into fitting until it stops.

6. This step for pressure regulator replacement:

Ensure cap O-ring is installed on cap. Lubricate O-ring with silicone grease.



CAUTION: Risk of product damage.

Petroleum-based lubricants will damage the plastic components of this valve, and should not be used.

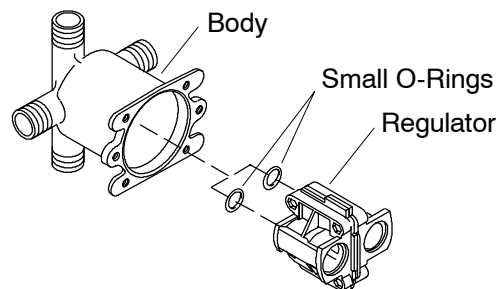

Fig. #5

7. Re-install cap subassembly. See Fig. #2 .

NOTE: This note for Black caps only: The stainless steel collar must be installed to the **outside** of the Black cap assembly, as shown in Fig. #2 .

8. This step for Brass cap only: Set maximum temperature before reinstalling handle, trim, and faceplate. See Fig. #6 . Loosen setscrew in collar. Remove collar from stem. Rotate stem clockwise to maximum water temperature desired. Place collar onto stem with setscrew against underside of the tab. Turn water off and tighten setscrew.

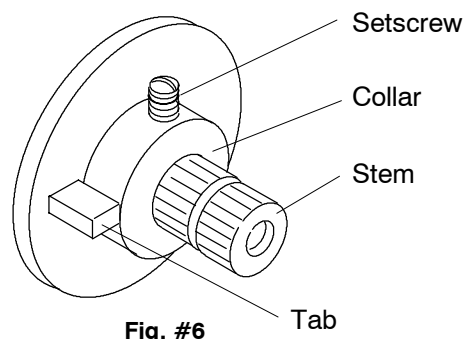

Fig. #6

9. Re-install faceplate and handle.

10. This step for Black caps only: For minor water temperature changes, adjust setscrew. For significant water temperature changes, remove O-ring and collar from valve stem. Rotate stem clockwise until desired maximum water temperature results. Replace collar on stem with setscrew against side of tab. Replace O-ring. Rotate stem counterclockwise to shut water off.

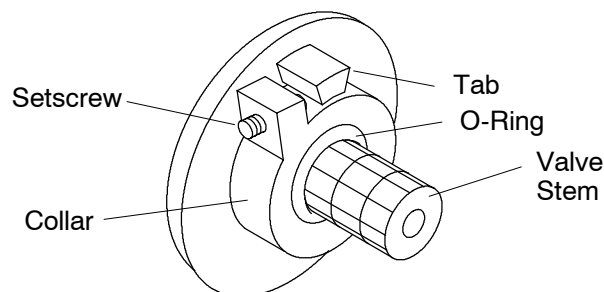

Fig. #7

11. Re-install faceplate and handle.