

# LED LUMINAIRE PANELS INSTALLATION INSTRUCTIONS



## **IMPORTANT - READ ALL INSTRUCTIONS BEFORE INSTALLATION**

- AC 100-347 V
- 50/60 Hz
- Power factor > 0.9
- Harmonic Distortion <20%
- 0-10 V dimming
- Warranty 5 years and 50 000 hours

**WARNING: Risk of Electric Shock. Suitable for damp and insulated locations. Not suitable for wet location.**

- Installation and maintenance must be performed by licensed electricians only.
- To avoid risk of electric shock, make sure to turn off main power switch prior to installation or maintenance.
- Must be installed in compliance with National Electrical Code (NEC) in the US or Canadian Electrical Code in Canada.
- Ensure input voltage and frequency is compatible with the fixture. Check product manual for power requirements prior to installation.

## **Caution**

- Before installation inspect luminaire for any exterior damages or other defects.
- Before installation confirm luminaire is the correct rated voltage for application
- During installation do not damage luminaire with drill or external impact
- Do not exchange LED module or other components in luminaire
- Must be grounded
- Minimum 90 °C supply conductors
- Access above ceiling required
- LED Panels are not suitable for covering with thermally insulating material.
- Please keep the LED Panel away from any corrosive substance, and please use dry cloth when you clean it
- This product must be installed in accordance with the applicable installation code by a person familiar with the construction and operation of the product and the hazards involved.

## **RECESSED INSTALLATION**

1. Bend hang buckle by 90° positioning it vertical to the rear cover of panel. Bend top of hang buckles horizontally 90°.
2. Turn off power and remove the old fixture from the ceiling.
3. Place the panel into the ceiling and use hang buckle to stabilize the panel on T-Bar. Secure to ceiling with aircraft cable for safety.

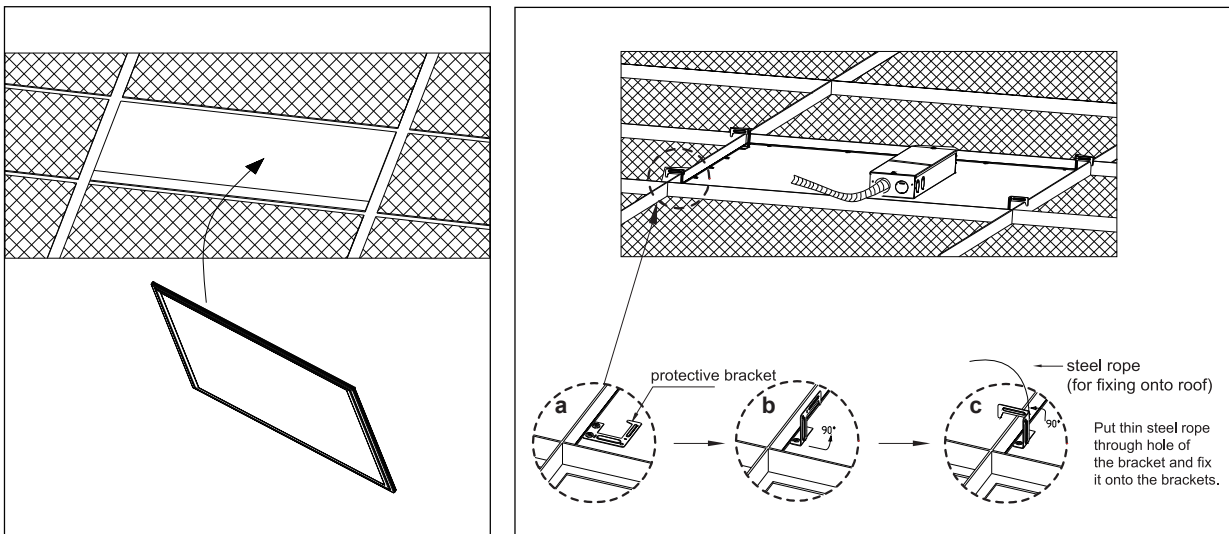

# LED LUMINAIRE PANELS INSTALLATION INSTRUCTIONS



## SUSPENSION INSTALLATION

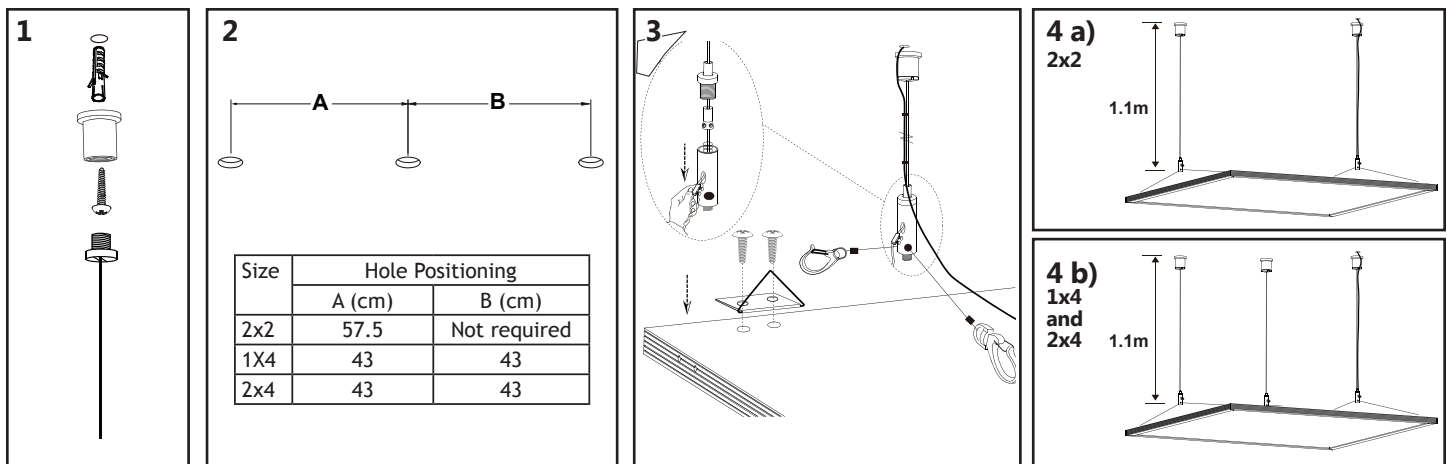

## WIRING DIAGRAM

### Single luminaire

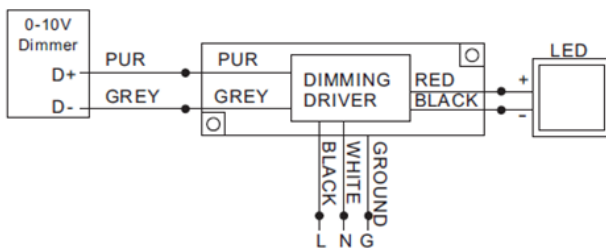

### Multiple luminaires

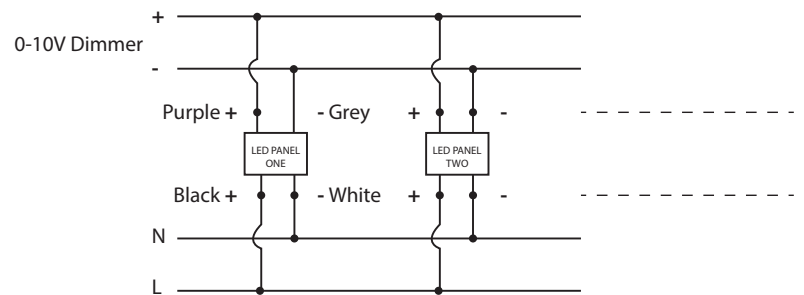

**1.** Open the junction box of LED Panel by removing the screw.

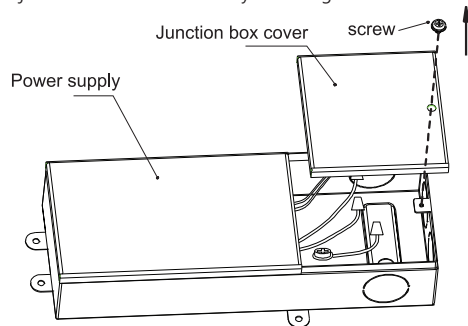

**2.** Make sure circuit is disconnected: Lead wire into junction box. Connect the white (N), black (L) and ground wire respectively in pairs. Cover with wire caps and make sure they are well connected.

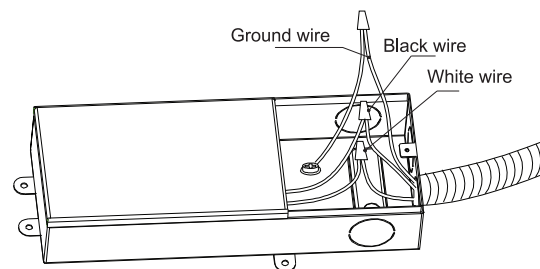

**3.** Lead wires into junction box : For Dimming: Connect purple (DIM+) and gray (DIM-) wires respectively in pair. Cover with wire caps and make sure they are well connected. For Non Dimming: Cap off wires with wire caps.

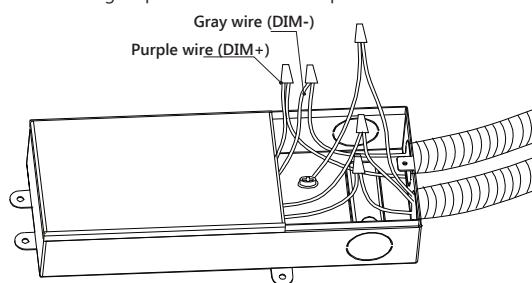

**4.** Close junction box with screw.

