

600 SERIES

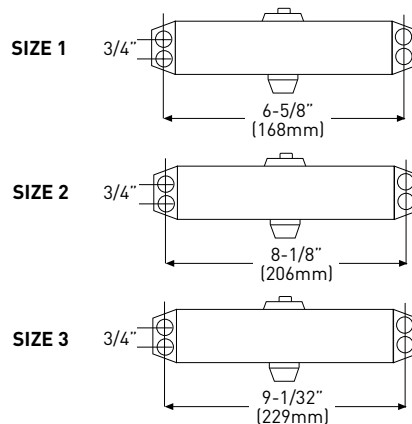

620 SERIES



### FEATURES OF 600 SERIES

- UL & C-UL LISTED
- 5 YEAR GUARANTEE
- MEETS OR EXCEEDS REQUIREMENTS OR BMHA/ANSI 156.4 - GRADE 3
- HIGH STRENGTH PRESSURE CAST ALUMINUM HOUSING
- FULL RACK AND PINION MECHANISM
- HEAT TREATED HIGH TENSILE ONE PIECE PISTON AND SPINDLE
- DUAL VALVE ADJUSTABLE (CLOSING AND LATCHING SPEED)
- REVERSIBLE FOR BOTH RIGHT AND LEFT HAND DOORS
- VERSATILE AND EASY INSTALLATIONS
- NARROW STYLE DESIGN, IDEAL FOR USE ON MODERN ALUMINUM AND GLASS DOORS, FIRE DOORS, STANDARD WOOD DOORS
- HIGH LUBRICITY AND LOW POUR POINT HIGH QUALITY HYDRAULIC FLUID
- LEAK PROOF "O" RINGS OIL SEAL
- UNIVERSAL MOUNTING (REGULAR AND PARALLEL BRACKETS INCLUDED)

FOR PRODUCT SPECIFICATIONS CONTACT YOUR TAYMOR SALES ASSOCIATE

	MAXIMUM RECOMMENDED DOOR SIZE & WEIGHT	ALUMINUM	BRASS	CASE PACK
1	36" x 84" [90cm x 210cm] 55-100 lbs/25 - 45 kg	14-602AL	14-602BR	10
2	38" x 84" [95cm x 210cm] 88-144 lbs/40 - 64 kg	14-603AL	14-603BR	10
3	42" x 96" [105cm x 240cm] 132-87 lbs/60 - 84 kg	14-604AL	14-604BR	10
DESCRIPTION		ALUMINUM	BRASS	CASE PACK
OPTIONAL PLASTIC COVER [600 SERIES]		12-C1600AL	14-C1600BR	10

DESCRIPTION	MAXIMUM RECOMMENDED DOOR SIZE & WEIGHT	ALUMINUM	BRASS	CASE PACK
DOOR CLOSER TRI-PACK DUAL VALVES	38" x 84" [95cm x 210cm] 88-144 lbs/40 - 64 kg	14-623AL	14-623BR	10