



Metering Faucets

Mechanical mixing valve with integral check valves

Model No: R2900-MIX

COMPLIES WITH:

- CSA certified.
- (Contact Delta Representative for State and/or Local Approvals)



SPECIFICATION:

- Solid brass body
- Valve only with built-in check valves
- Mechanical mixer with adjustable temperature setting, temperature control handle and vandal resistant screw to lock-in selection
- 3/8" compression inlets and outlet connections
- Maximum rated working pressure 125 psi

OPERATION:

- Not Available

(Dimensional drawing on following page)

Delta reserves the right (1) to make changes to specifications and materials, and (2) to change or discontinue models, both without notice or obligation. Dimensions are for reference. Measurement may vary plus or minus 6mm(0.25"). Mounting locations are suggested only. Check with local codes for requirements in your area. This spec was produced March 18, 2013.

Delta Faucet Company - 55 East 111th St. - Indianapolis, Indiana, USA 46280 - (317) 848-1812
Delta Faucet Canada - 395 Matheson Blvd E - Mississauga, Ontario, Canada L4Z 2H2 - (905) 712-3030

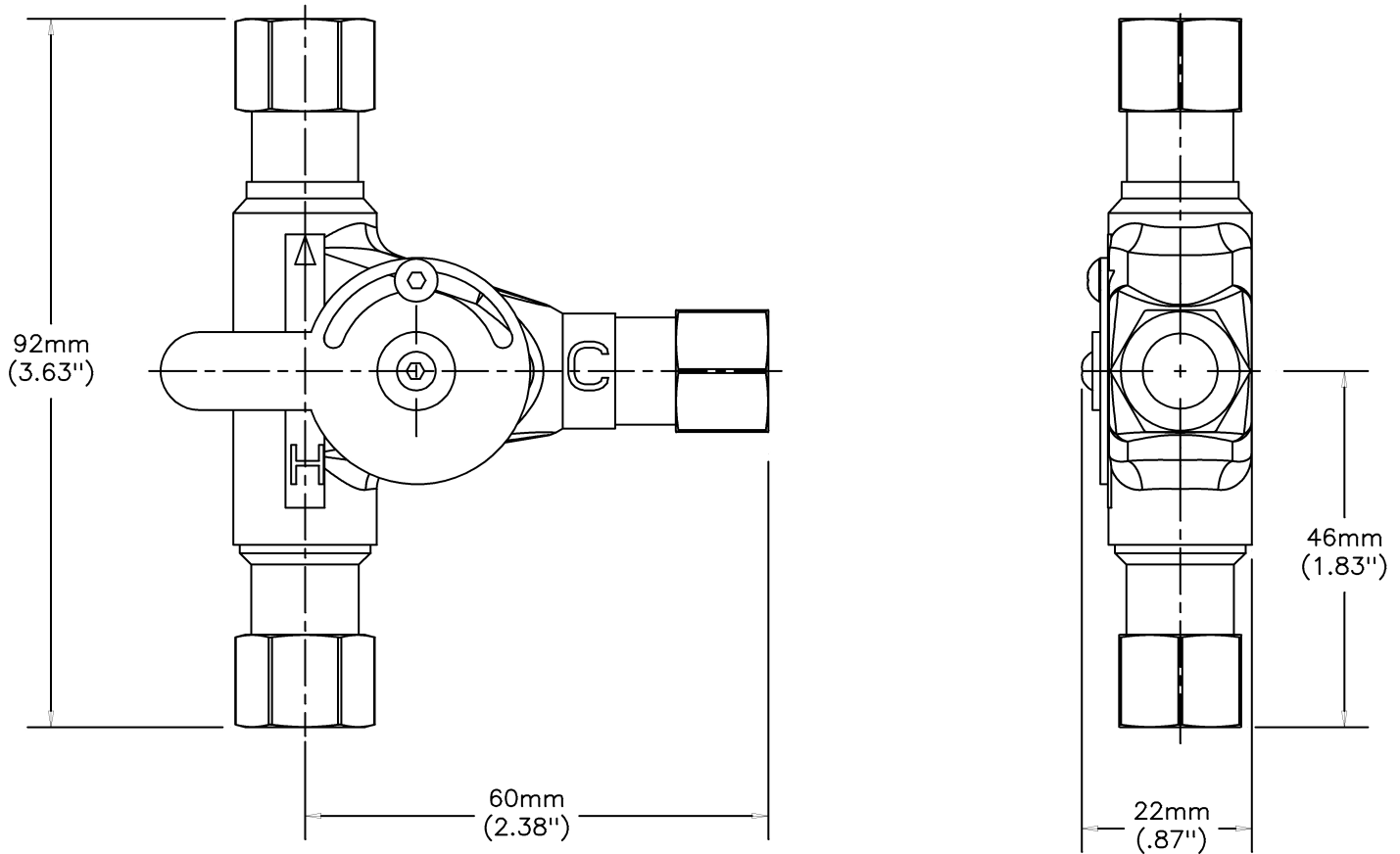

3/8" COMPRESSION CONNECTIONS ON INLETS AND OUTLET

Delta reserves the right (1) to make changes to specifications and materials, and (2) to change or discontinue models, both without notice or obligation. Dimensions are for reference. Measurement may vary plus or minus 6mm(0.25"). Mounting locations are suggested only. Check with local codes for requirements in your area. This spec was produced March 18, 2013.

Delta Faucet Company - 55 East 111th St. - Indianapolis, Indiana, USA 46280 - (317) 848-1812
 Delta Faucet Canada - 395 Matheson Blvd E - Mississauga, Ontario, Canada L4Z 2H2 - (905) 712-3030