

# COLUMBIA

5000 SERIES  
BATHWARE

Taymor®



## AVAILABLE FINISHES

SATIN NICKEL  
C15



POLISHED CHROME  
C26



## FEATURES

- EXPOSED SURFACE MOUNT
- LIFETIME WARRANTY
- MOUNTING HARDWARE AND INSTALLATION INSTRUCTIONS INCLUDED



# COLUMBIA

## 5000 SERIES BATHWARE

CONSTRUCTION: ZAMAC (DIECAST ZINC ALLOY)

INCLUDES NYLON ANCHORS AND STEEL PHILLIPS HEAD SCREWS — #8 x 1-1/4" [32mm]

|     |                 | TOWEL BAR<br>TUBE SIZE | TOWEL BAR<br>TUBE MATERIAL | TOWEL RING<br>TUBE MATERIAL | STANDARD<br>PAPER HOLDER<br>ROLLER MATERIAL | PAPER HOLDER/<br>TOWEL HOLDER<br>MATERIAL |
|-----|-----------------|------------------------|----------------------------|-----------------------------|---|---|
| C15 | SATIN NICKEL    | 5/8" [16mm]            | ALUMINUM                   | ALUMINUM                    | PLASTIC                                     | ZINC ALLOY                                |
| C26 | POLISHED CHROME | 5/8" [16mm]            | ALUMINUM                   | ALUMINUM                    | PLASTIC                                     | ZINC ALLOY                                |

### TOWEL BAR

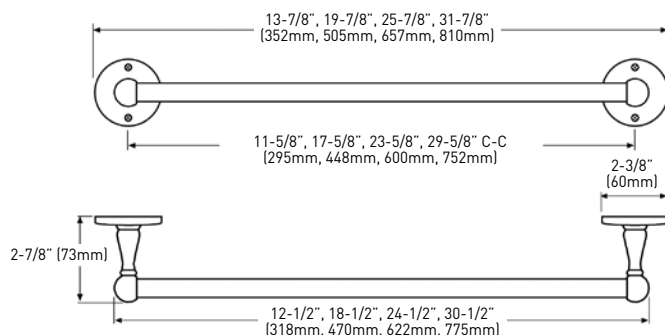

### SINGLE ROBE HOOK

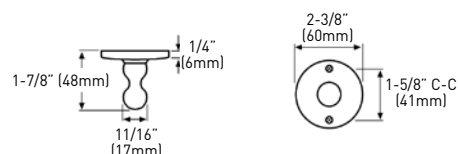

### TOWEL RING

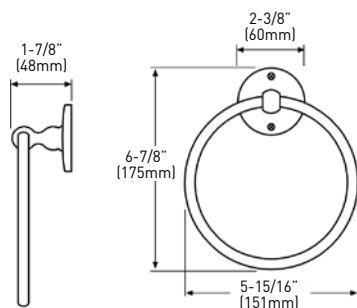

### STANDARD PAPER HOLDER

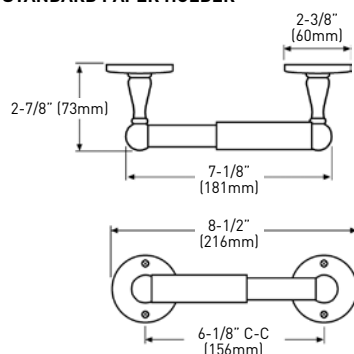

### PAPER HOLDER

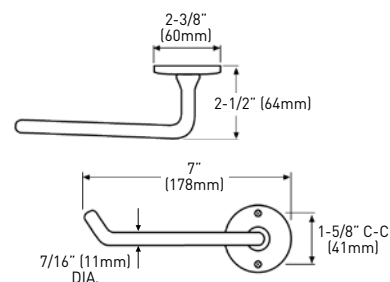

MEASUREMENTS SUBJECT TO A 3% VARIANCE.

| PHOTO | DESCRIPTION  | SATIN NICKEL<br>C15                           | POLISHED CHROME<br>C26                       | CASE<br>PACK     |
|-------|--|---|--|------------------|
|       | 12" x 5/8" TOWEL BAR<br>18" x 5/8" TOWEL BAR<br>24" x 5/8" TOWEL BAR<br>30" x 5/8" TOWEL BAR | N/A<br>02-D5018SN<br>02-D5024SN<br>02-D5030SN | 02-D5012<br>02-D5018<br>02-D5024<br>02-D5030 | 4<br>4<br>4<br>4 |
|       | SINGLE ROBE HOOK   | 02-D5001SN                                    | 02-D5001                                     | 4                |
|       | TOWEL RING   | 02-D5004SN                                    | 02-D5004                                     | 4                |
|       | STANDARD PAPER HOLDER  | 02-D5008SN                                    | 02-D5008                                     | 4                |
|       | PAPER HOLDER   | 02-D5048SN                                    | 02-D5048                                     | 4                |